

# SPARE PARTS CATALOGUE USER MANUAL

*PASTRY  
MACHINES*



## MANUAL DOUGH SHEETERS

CE

mod. SZ505BN  
SZ507BL  
SZ507  
SZ510  
SZ610BL  
SZ610

**We are delighted to welcome you as one of our customers and are certain that the machine you have bought will meet all your needs and expectations.**

The pasta rolling machine the manual refers to, is why Our Company is famous all over the world for its reliability and quality. We use the most modern mechanical technologies to make machines reliable and safe for users. All our machines conform to international norms on operational safety for users and on the healthiness of construction material destined to come into contact with food products.

<b>MACHINES</b>	<b>INDEX</b>	<b>PAGES</b>
<b>SZ 500</b>	• General part .....	1
<b>SZ 600</b>	• General safety norms .....	2
<b>MOD.:</b>	• Handling.....	3
<b>SF 505 BN</b>	• Signals and safety devices.....	4-5
<b>SZ 507 BL</b>	• Installation .....	5
<b>SZ 507</b>	• Connection to electricity.....	6
<b>SZ 510</b>	• Machine identification.....	6
<b>SZ 610 BL</b>	• Size and overall dimensions.....	7
<b>SZ 610</b>	• Machine description .....	8
	• Rolling groups .....	8
	• Machine use .....	9
	• Machine maintenance.....	10
	• General rules for dismantling the machine.....	10
	• Cinematic motion assembly Table.1.....	11
	• General assembly Table.2 .....	12
	• Electric plant.....	13

The manufacturing company, in order to continue improving its product, reserves the right to bring about, at any moment, changes to mechanical parts, details or accessories.

# **GENERAL SAFETY NORMS**

## **General:**

Accidents that happen in the workplace do not occur by chance: every accident is the last ring in a chain of mistaken events, or of non-safety conditions or both.

The control, management, maintenance and safety systems are sufficient to guarantee operator safety, a good product, in good hygiene conditions, together with safeguarding and maintaining plant efficiency.

**Adhere to the instructions in this manual and do not try, in any way, to tamper with or modify the mechanical or electronic safety systems.**

- **General behaviour rules for safety operators**

Here below you will find some general observations to be followed continuously.

1\_ Access to working areas must only be for authorised personnel.

2\_ Personnel must wear suitable clothing for the work to be done, to safeguard personal safety, hygiene and to avoid any damage to the machine; avoid wearing wide clothes, loose hair, watches, rings, chains or anything else that could get caught in the machine's moving parts.

3\_ Do not assign machine maintenance or repairs to those operating under the influence of alcohol, drugs, sedatives or to anyone who is clearly tired.

4\_ Do not carry out of your own initiative operations or intervention not foreseen in your specific responsibilities or not included in this manual: avoid using instruments that are not suitable for the job to be done.

5\_ Start up the machine only after having completely understood how it works.

6\_ Make sure that the fixed and mobile grills are in the right position during operations: use of the machine without grills can cause serious problems to people.

7\_ Before any intervention on equipment inside or outside the panel, switch off electricity using the main switch.

8\_ Keep all access routes and the work areas around the machine clean, dry and empty; make sure that in the immediate vicinity of the plant, space for personnel to move through and for the movement of other transport machines is adequate.

9\_ Avoid leaving any object on the machine.

10\_ Make sure that lighting in the machine area is excellent as foreseen by regulations.

11\_ At the end of each working day, or anyway, of each working cycle, check that all switches, limit switches and safety devices are working; turn the machine off with the main switch and make sure you turn off the electricity at the main panel.

12\_ Carefully observe all safety norms foreseen by the laws in force.

13\_ Not respecting the regulations can cause problems or machine malfunctioning and an interruption of the guarantee. The manufacturer declines all responsibility for damage to people or things due to incorrect machine use.

The manufacturer is not responsible for damage to persons or things caused by not respecting the above mentioned regulations.

# HANDLING

PHASE 1

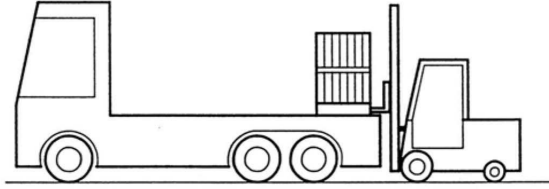

PHASE 2

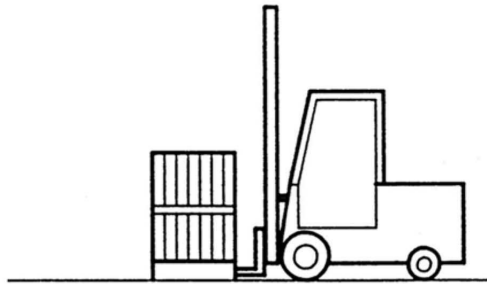

PHASE 3



PHASE 4



## **SIGNALS AND SAFETY DEVICES**

Our machines are designed with fixed and mobiles grills to protect the user from dangers coming from the parts in movement. They are also supplied with data plates conforming to safety norms thus giving operators the possibility to work in complete safety.

**ATTENTION** The company declines all responsibility for damage caused to persons or things deriving from changes made to the machine or to parts of it, removal of grills or of safety devices.

### **DANGER SIGNALS**



**BE CAREFUL!  
DANGER  
HAND SQUASHING**



**220 V.**

**BE CAREFUL!  
DANGER  
ELECTRIC TYPE**



**380 V.**

**BE CAREFUL!  
DANGER  
ELECTRIC TYPE**

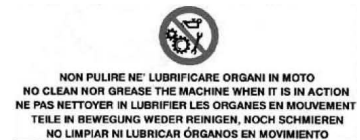

**BE CAREFUL!  
MOVING PARTS**

*IT IS ABSOLUTELY FORBIDDEN TO REMOVE THE ABOVE SIGNALS AND THEY MUST BE REPAIRED IF THEY SHOULD BE ILLEGIBLE.*

### **NORMS FOR INSTALLATION OF THE MACHINE**

All the equipment used and the means made available by the Customer ( transporters, cranes, forklift trucks, cables, belts, clamps etc....) must be approved for safety guarantee for the loads required, and able to operate in the specific conditions of the installation areas ( size of rooms, floor capacity etc....)

The company has no responsibility for accidents caused by not respecting said norms.

### **BE CAREFUL:**

All lifting and transport means used must be compatible with the work environment; those letting off harmful fumes must not be used in places where food products are handled.

## RECOMMENDATIONS:

We recommend you follow the following regulations to install the machine:

- Organize the area where the machine is going to be placed suitably.
- Only authorised personnel must be allowed to access the work area.
- Personnel involved in assembling the machine must be equipped with suitable clothes and material to protect their safety ( safety shoes, gloves etc....) .
- If the machine is mounted on a pallet, make sure that it is well fixed to it to avoid danger to persons or damage to the machines on unloading .
- We recommend that the machine be placed on the ground carefully to avoid blows that can damage it.
- Based on component weight, use suitable lifting equipment.
- Check and make sure that when placing the machine you do not cause danger and/or difficulty for the installation of other machines or to authorised personnel.
- Make sure that the openings and the passage for the handling of the machine are suitable.
- Make sure that the work area has excellent lighting.
- Before installing the machine make sure that the floor it is to be installed on is well levelled.

**The manufacturer will not be held responsible for damage to people or things if the above regulations are not respected.**

## ASSEMBLY

Unlock the appropriate hook in order to rest the plane on the bench (FIGURE 1.).



FIGURE 1.

## CONNECTION TO ELECTRICITY

### BE CAREFUL!

To carry out any maintenance inside the electric panel, switch off the main switch. Check that the network voltage is the same as what is needed for the machine (check the machine's identification plate).

## MACHINE IDENTIFICATION

Each rolling machine has its own identification plate which includes the main features; this plate is easy to find. The data found on the plate refers to your machine and its features, certifying that it complies with the laws in force. This plate must not be removed nor used for other purposes for any reason; if the cutting machine should be dismantled, make sure the plate is destroyed.

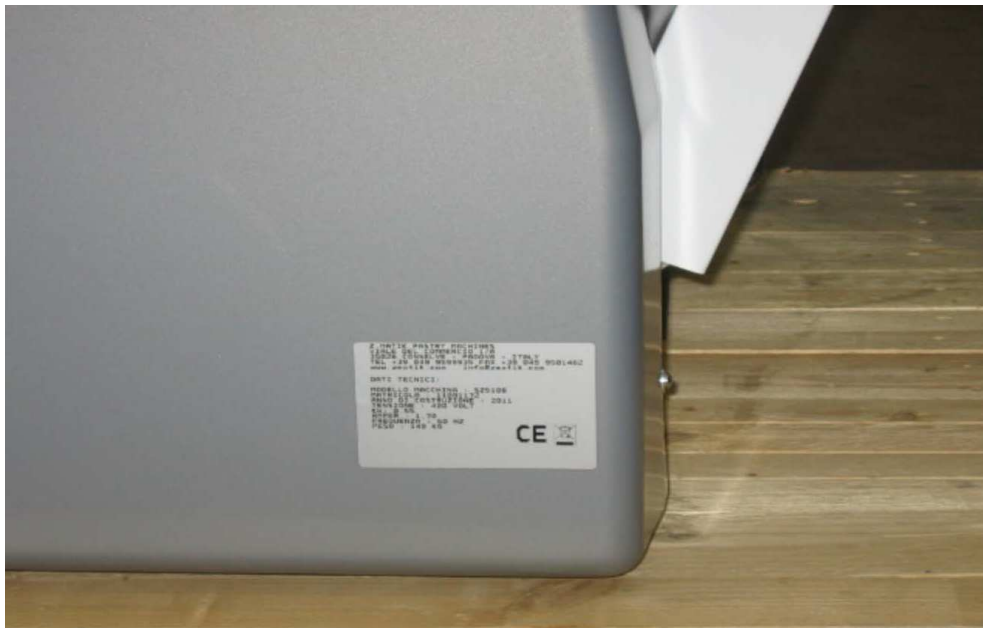

UE INDICATION PLATE (ON BACK OF MACHINE)



INDICATION PLATE

## SIZES AND OVERALL DIMENSIONS

<b><u>TECHNICAL DATA</u></b>	<b>505BN</b>	<b>507BL</b>	<b>507</b>	<b>510</b>	<b>610BL</b>	<b>610</b>
<b>Length A</b>	1200	1750	2200	2500	2500	2500
<b>Width B</b>	900	900	900	1000	1000	1000
<b>Height C/G</b>	710	710	1370	1370	710	1370
<b>Belt length D</b>	500	700	750	1000	1000	1000
<b>Belt width E</b>	500	500	500	500	600	600
<b>Work top height from floor F</b>	520	520	770	770	770	770
<b>Motors: power hp</b>	0.75	0.75	0.75	0.75	1	1
<b>Motors: abs. kWh</b>	0.55	0.55	0.55	0.55	0.75	0.75
<b>Net weight</b>	130	140	200	210	220	230

In the table above there are data for each dough sheeter.

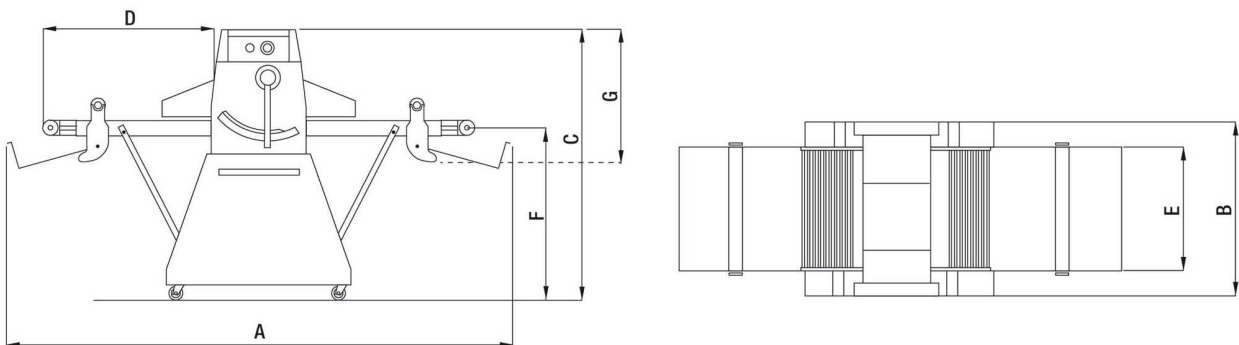



# MACHINE DESCRIPTION

## WORKINGS

The “SZ” rolling machine is used for rolling pasta. The pasta goes through the cylinders which in turn can be regulated to obtain different thicknesses.

## MACHINE COMPONENTS

A strong structure in painted steel, composed of a base MOD. SZ507-510-610 with four self-blocking wheels in it, to facilitate movement; the electric panel and the traction motor. Two sides holding all the cinematic parts are covered with removable panels. Two strong arms in painted steel, complete with conveyor belts, with different speeds, allowing the pasta to move along them.

### Section plane of the machine's ROLLING CYLINDER GROUP

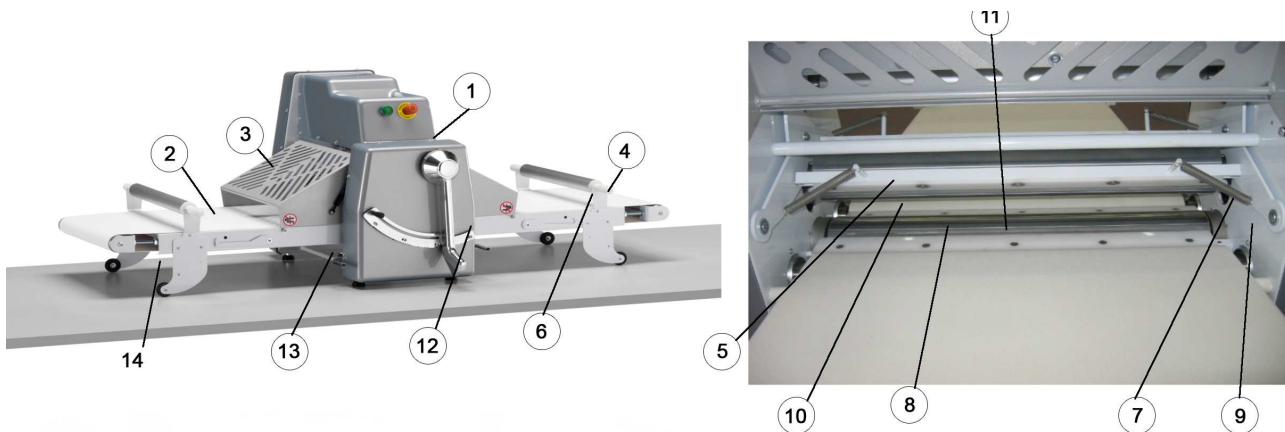

**Legend:**

- 1. ZLFS501032N
- 2. TAPP.
- 3. ZLCT0010211
- 4. ZTCS5PC016
- 5. ZTCS501012
- 6. ZLSS001002
- 7. ZLSS001115
- 8. ZFAS501031
- 9. ZFCS501039P
- 10. ZFCS501030
- 11. ZFCS501038P

- Side
- Conveyor belt
- Protection
- Idle roller belt tightener
- Sheeter cylinders
- Rolling pin support
- Upper scraper support clamp
- Upper scraper support
- Upper scraper
- Lower scraper support
- Lower scraper

- 12. ZSF500B000
- 13. ZSF500B000
- 14. ZTCS601067
- Lever to start machine on the right
- Lever to start machine on the left
- Drive cylinder

**N.B.** With a simple operation the scrapers can be dismantled to clean them better.

## MACHINE USE

Check that the belts are in the right direction, to do that use lever (fig. 6).

The machine does not work if the safety guards (grills) are not lowered correctly ( fig.7 )

The micro switches 1 (fig. 8) limit functioning.

### **BE CAREFUL!**

The protection grills must not be used to stop the machine. For this, release the pedal or press **STOP**.

### **IMPORTANT**

If the machine does not work, before checking further, make sure the machine panel gets electricity and that the protection grills are lowered.

In fig.9 you can see that the rollers can be brought nearer or moved further away by moving lever 1, going to the right or the left you can change the opening/closing of the rollers thanks to the specific serrated sector 2, checking the thickness desired on indicator 3. The pasta thickness can vary from 0 a 47mm.



Fig. 6



Fig. 7



Fig. 8

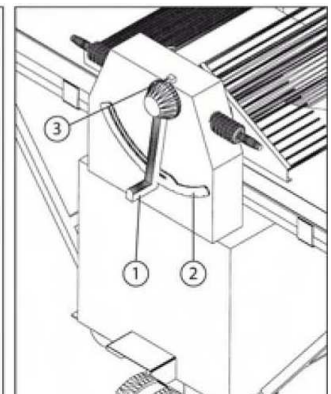

Fig. 9

## **MACHINE MAINTENANCE**

After a production cycle lasting hours (that can vary) it is a good rule to clean the machine carefully; clean the upper and lower scrapers on the rollers very well.

If the conveyor belt slips, tighten the regulating screw till the belt fits into its initial working position.

### **BE CAREFUL!**

Take great care when using jets of water in the machine operating area for electricity safety reasons and for possible machine mal-functioning.

## **GENERAL RULES FOR MACHINE DISMANTLING**

Machine dismantling must be carried out by a specialised technician. In any case, please read the machine description in this manual carefully in order to be sure how things work and to organise the dismantling operations.

**SAFETY PRECAUTIONS** Authorised personnel must be specialised and aware of the different problems, take all the suitable safety precautions to protect yourself and others.

## **DIFFERENT MATERIAL CLASSIFICATION**

When dismantling the machine, materials should be carefully separated for recovery:

Normal steel: base, structure, arm (N.B. can be stainless steel )

Stainless steel: all parts coming into contact with the product

Special steel: shafts, ball bearings, chains etc..

Various: electric motors, electric cables, etc..

N.B. Observe all national or local regulations for the dismantling of environmentally polluting materials.

## **GENERAL INDICATIONS FOR THE DISMANTLING PROCEDURE**

- Unplug and disconnect electricity
- Remove the electric panel and controlling equipment
- Remove the independent groups ( motors, chains, gears, etc.. ) until the machine structural material is left.

**BE CAREFUL!** The machine's data plate must be destroyed so that it cannot be used for other purposes.

Once the machine has been dismantled, this manual is no longer valid.

## CINEMATICS MOTION ASSEMBLY

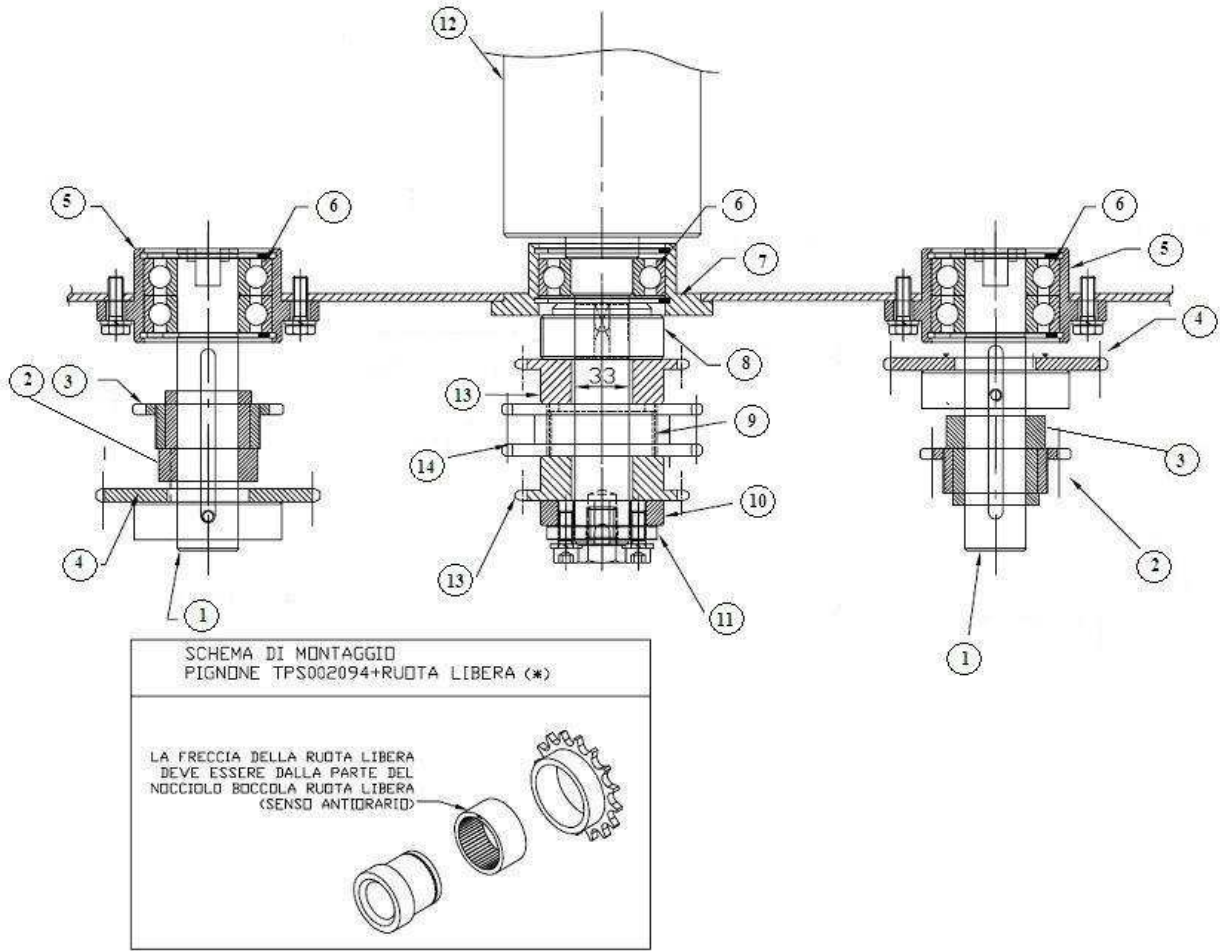

<u>POS.</u>	<u>CODE</u>	<u>DENOMINATION</u>
1	ZTPS001062	PULL CYLINDER PIN
2	ZTPS002094A	PINION
3	ZTPS002096	FREEWHEEL
4	ZTPS002091	PINION
5	ZTSS001069	DRIVE SHAFT SUPPORT
6	ZTCS602130	BALL BEARING
7	ZTSS001080	SUPPORT
8	ZTDS001052	FRONT CLUTCH SPACER
9	ZTAS001098	THREADED ROD
10	ZTDS001082	REAR CLUTCH SPACER
11	ZTRS001055	CLUTCH WASHER LID
12	ZCTS601068	LOWER CYLINDER CALIBRATOR
13	ZTPS002094	PINION
14	ZTAS001097	PINION

## GENERAL ASSEMBLY

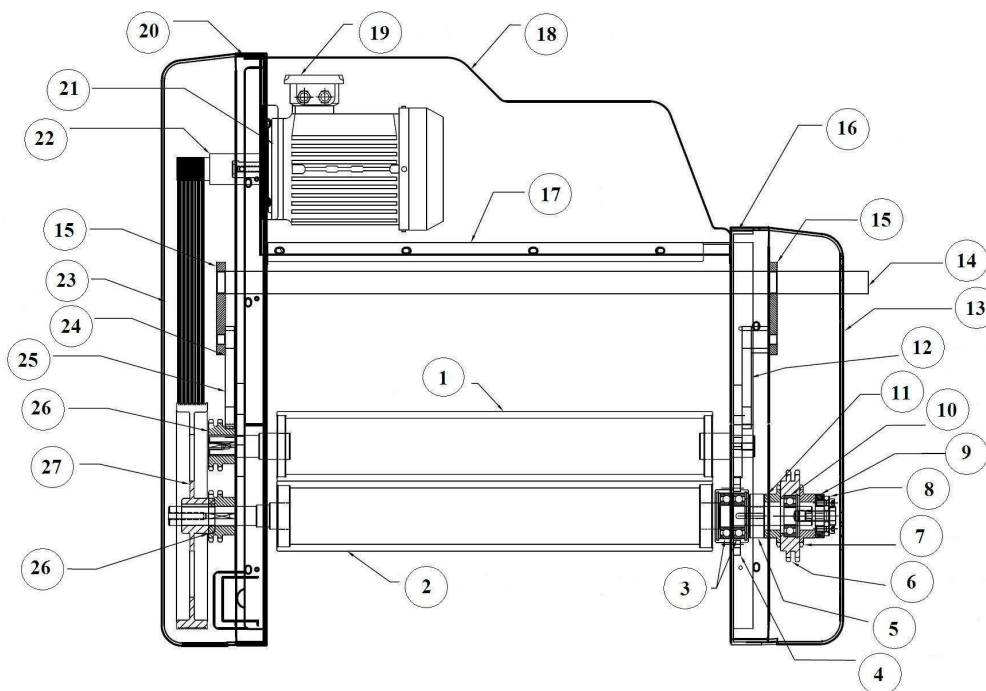

<u>POS.</u>	<u>CODE</u>	<u>DENOMINATION</u>
1	ZCTS501014	UPPER CYLINDER CALIBRATOR
2	ZTCS501012	LOWER CYLINDER CALIBRATOR
3	ZCTS602130	BALL BEARING
4	ZTSS001069	DRIVE SHAFT SUPPORT
5	ZTDS001052	FRONT CLUTCH SPACER
6	ZTPS002095	PINION
7	ZTPS002094	PINION
8	ZTRS001055	CLUTCH WASHER LID
9	ZTDS001082	REAR CLUTCH SPACER
10	ZTCS602129	BALL BEARING
11	ZTPS002094	PINION
12	ZLSS001018B	ASSEMBLY UPPER CYLINDER LEVER
13	ZSF500B003P	THERMOFORMED RIGHT PANEL
14	ZTAS501006	UPPER ROD
15	ZFBS001056	HANDLE PISTON ROD
16	ZSF500B001	RIGHT SIDE PANEL
17	ZSF500B005	ELECTRICAL SYSTEM SUPPORT
18	ZSF500B005P	CARTER SWITCHBOARD
19	ZACS501249	ENGINE
20	ZSF500B002	LEFT SIDE PANEL
21	ZSF500B019	CARTER ANGLE BRACKET
22	ZSB500B101	ENGINE PULLEY
23	ZSF500B004P	THERMOFORMED LEFT PANEL
24	ZFBS001065	LOWER PISTON ROD
25	ZLSS001018	UPPER CYLINDER LEVER
26	ZTPS002093	PINION
27	ZTPS501025	PULLEY



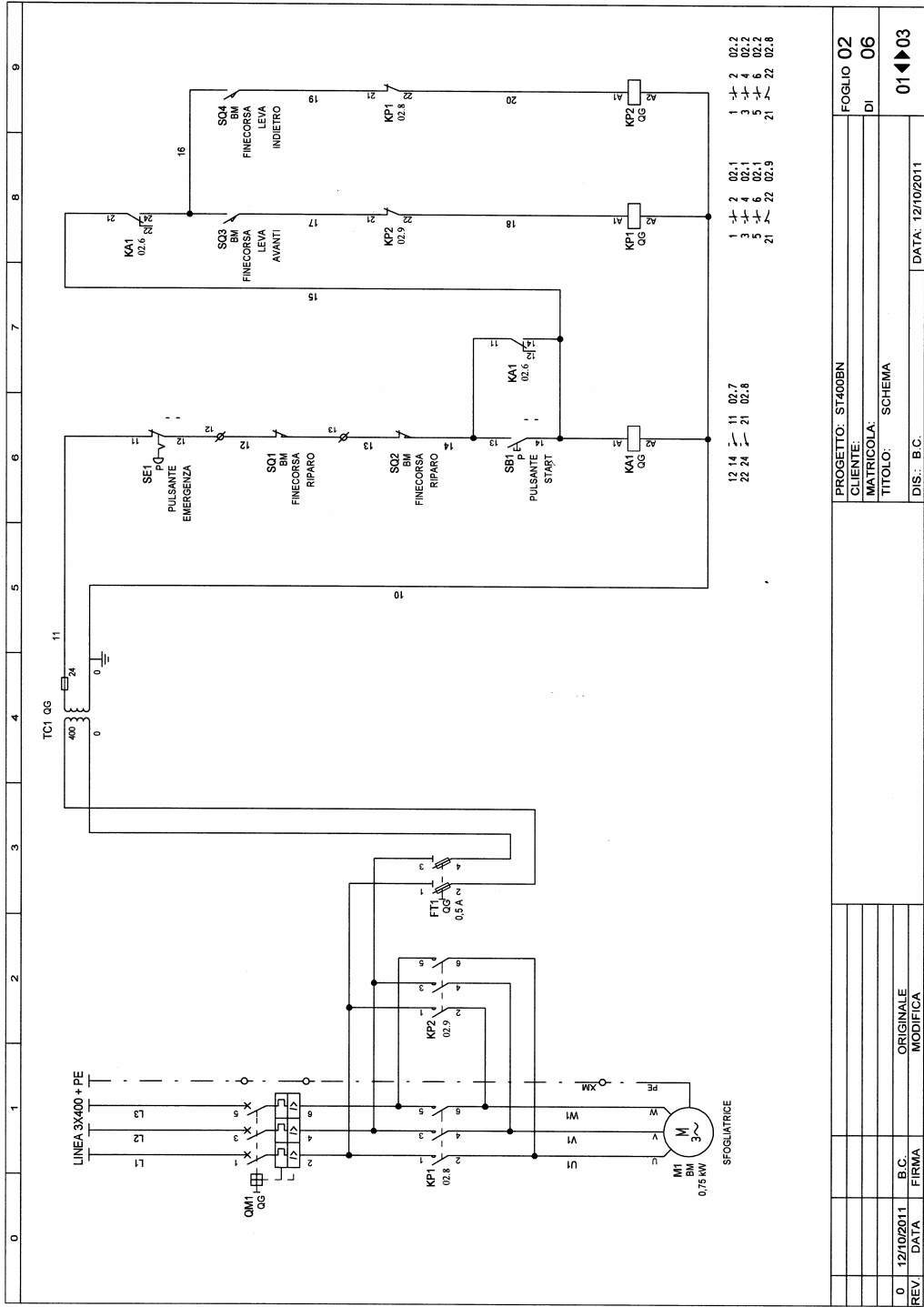

PROGETTO: ST4003N	FOGLIO 02
CLIENTE:	DI 06
MATRICOLA:	
TITOLO: SCHEMA	
DIS.: B.C.	DATA: 12/10/2011
0 12/10/2011 B.C.	01 ◀ 03
REV. DATA FIRMA	ORIGINALE MODIFICA

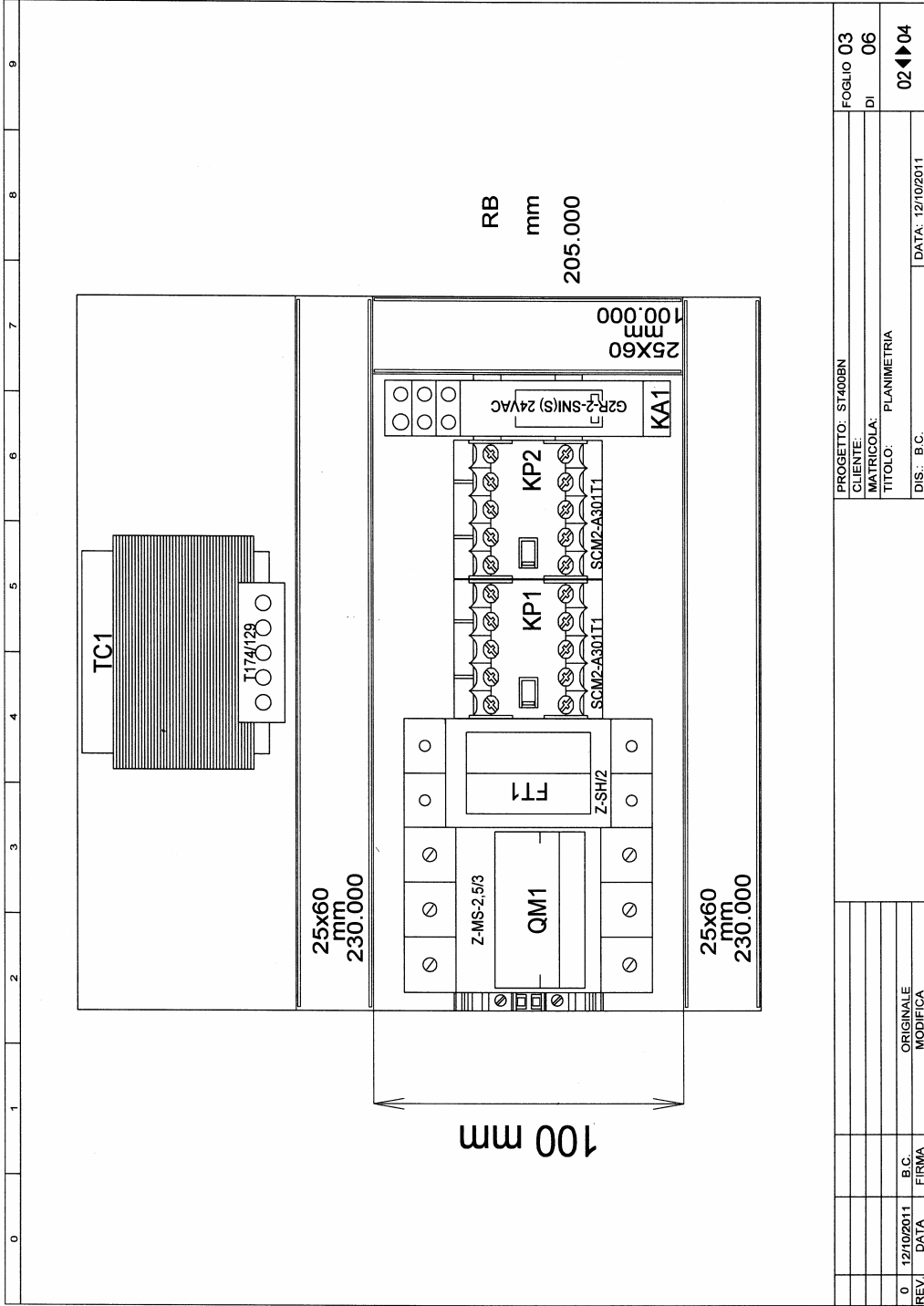

PROGETTO: ST400BN	Foglio 03
CLIENTE:	DI 06
MATRICOLA:	
TITOLO: PLANIMETRIA	
DIS.: B.C.	DATA: 12/10/2011
	02 ◀▶ 04







